

~~FLAT 06~~

~~ONE BEDROOM  
520 SQ.FT.  
PLUS BALCONY 155 SQ.FT.  
TOTAL 675 SQ.FT.~~



414 - 25 OXLEY STREET  
1 BEDROOM  
APPROX. 520 SQ.FT. ✓

POPE LOGO ✓

Move building template to this side somewhere under above info.

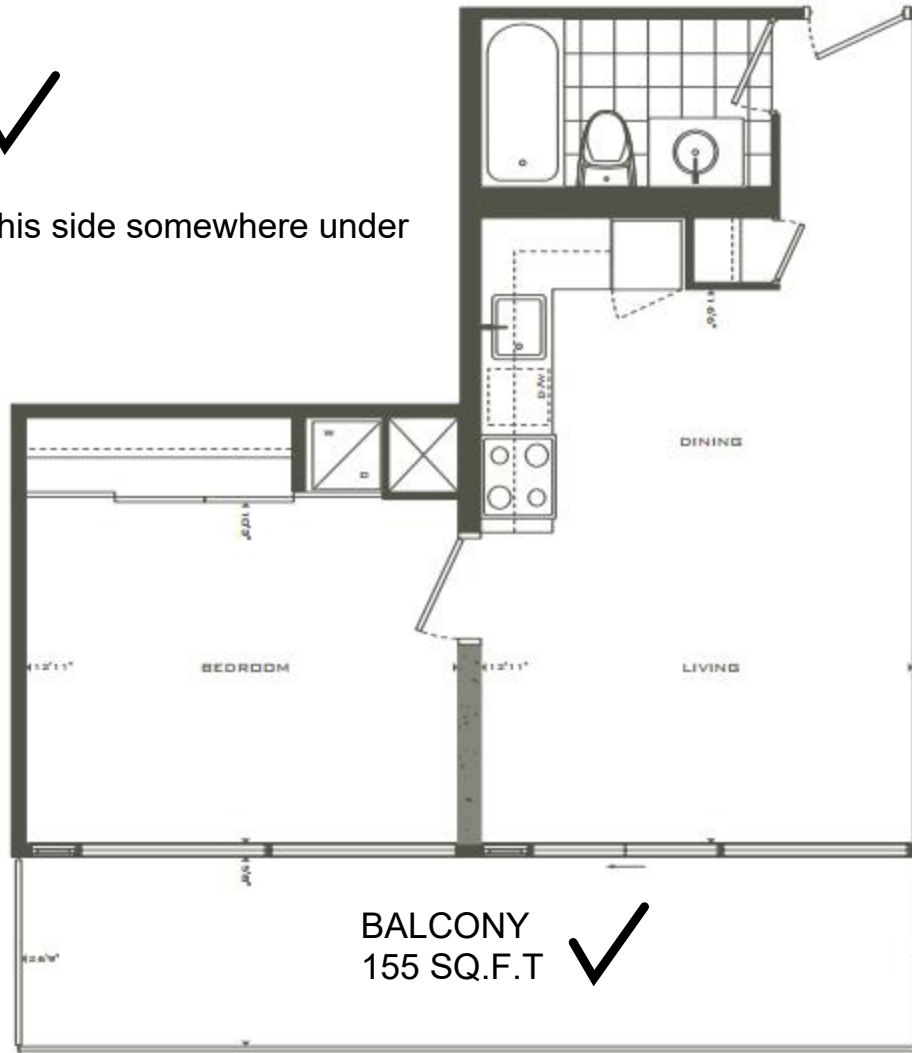

BALCONY  
155 SQ.F.T ✓

Pope Contact Info ✓



Disclaimer ✓